

7	2258-3311-TMT-ESR10-GEN07	A	SUPPORT 5		24.34	2	48.68
6	2258-3311-TMT-ESR10-GEN06	A	SUPPORT 4		21.26	2	42.52
5	2258-3311-TMT-ESR10-GEN05	A	SUPPORT 3		18.04	2	36.08
4	2258-3311-TMT-ESR10-GEN04	A	SUPPORT 2		10.21	2	20.42
3	2258-3311-TMT-ESR10-GEN03	A	SUPPORT 1		60.80	1	60.8
2	2258-3311-TMT-ESR10-GEN02	A	SECOND STAGE AIR-EXHAUST		90.07	2	180.14
1	2258-3311-TMT-ESR10-GEN01	A	SECOND STAGE AIR-COMBUSTION		199.27	2	398.54
N°	PART NUMBER / ARTICLE CODE	REV.	DESCRIPTION	MATERIAL	WEIGHT (KG)	QTY.	TOTAL WEIGHT (KG)

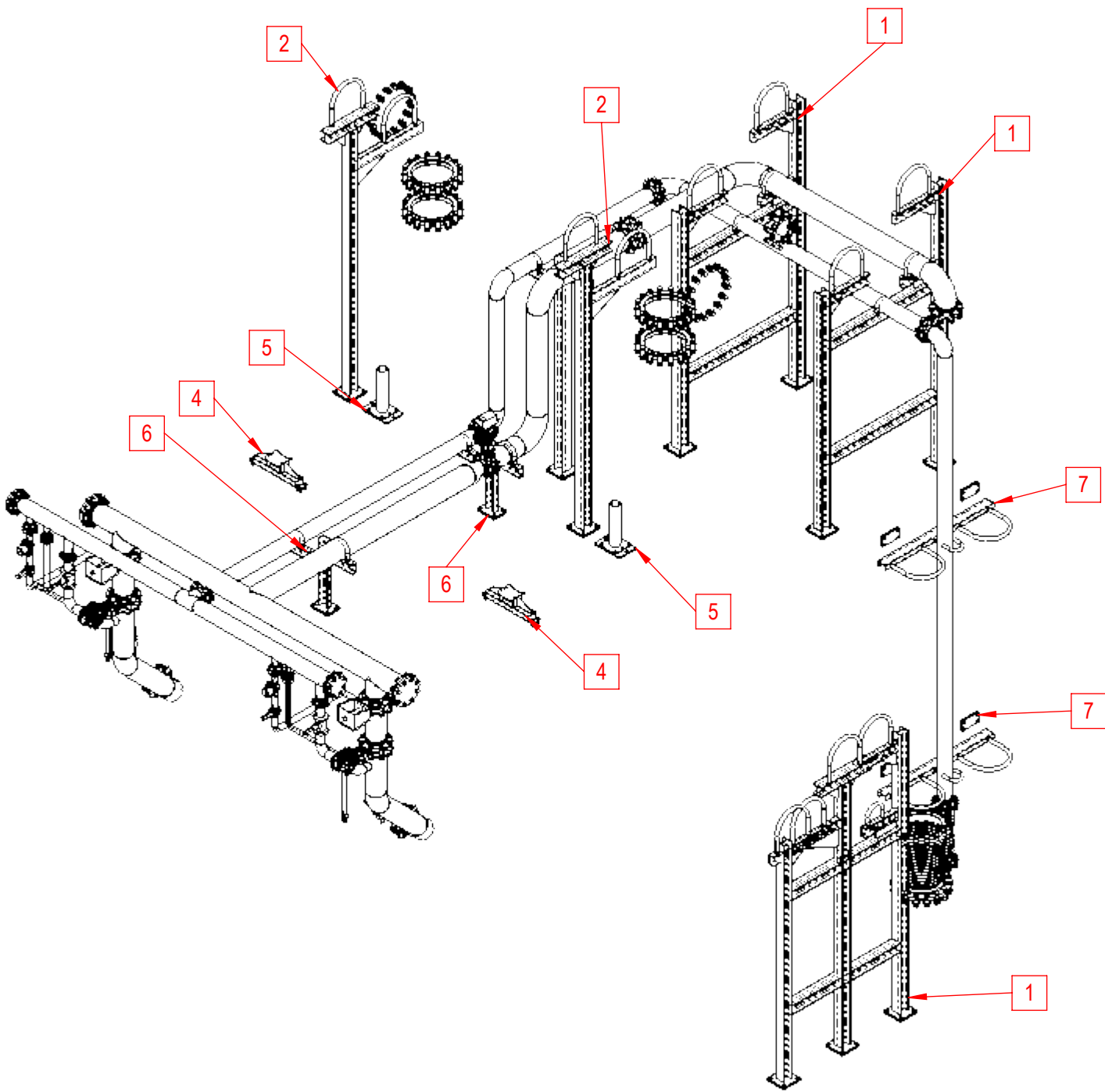

(1:50)
ISOMETRIC VIEW

Rev.		Modification										Name		Date					
This drawing is property of INSERTEC. Must not be copied or transferred to third parties in any way without written authorization.																			
Tolerance for dimensions without tol. according to ISO 2768-mK												Name		Date		Material			
More than		0.5	3	6	30	120	400	1000	2000	Draw		J.M.G.C		04/12/2025					
Less		3	6	30	120	400	1000	2000	4000	Checked		O.A.P.M.		04/12/2025		Weight (kg)			
Machine Tool		±0.1	±0.1	±0.2	±0.3	±0.5	±0.8	±1.2	±2	Verified		B.U.		04/12/2025		787.17			
Welded			±0.5	±1	±1.5	±2	±3	±4	±6										
Customer:										Format:		Title							
<div>ALINVEST</div>										A2		<div>ALINVEST TMT (FVRB-2,5-35) ESR10-SPOOLS</div>							
										Scale:									
										1:50									
<div><div>insertec</div><div>Furnaces & Refractories</div></div>										Project Methode:		Part Number						Revision	
												2258-3311-TMT-ESR10_SPOOLS						A	
												Customer Number						Sheet	
												1/1							

insertec
Furnaces & Refractories

